



HIP



DOCUMENTATION

FIRST INTENTION STRAIGHT STEM
CEMENTED OR CEMENTLESS - STANDARD OR LATERALIZED

Hip & go

Femoral stem

The Hip'n go cemented and cementless straight stems are self-locking stems based on a conventional design.

Concept

The universal Hip'n go concept offers the choice, pre or peroperatively, between using a standard cemented or cementless stem (CDD angle 130°) or a lateralized cemented or cementless stem (CDD angle 122°). The tulip shape of the metaphysis and the anteroposterior and lateral macrostructures for the cementless version facilitates primary fixation of the stem; a T40 porous titanium spray and an HAP coating facilitate secondary fixation.

Range and Materials

The range of straight Hip'n go stems include 10 sizes, available in 130° and 122°.

The cementless range of implants is made out of TA6 V4 titanium alloy. The outside surface has a T40 titanium spray and hydroxyapatite coating.

The cemented range of straight stems are made out of M30NW stainless steel, with a mirror-polished surface to comply with cemented stem standards.

Taper and neck

The neck is fitted with a 12/14 taper, enabling it to be used with an alumina head. The taper is flattened in the anteroposterior section and reduced below the neck to a diameter of 11mm to increase the ROM (Range of Motion).

Metaphysis

The tulip shape of the metaphysis and the macrostructures enable primary fixation. The proximal part of the metaphysis includes a semi-circular groove for guided impaction and a screw thread to facilitate extraction of the stem, if necessary.

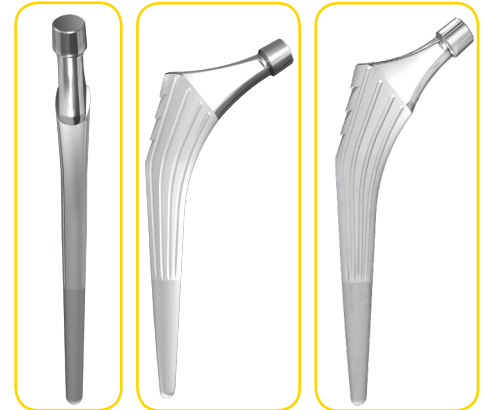

122° Cementless Stem 130° Cementless stem

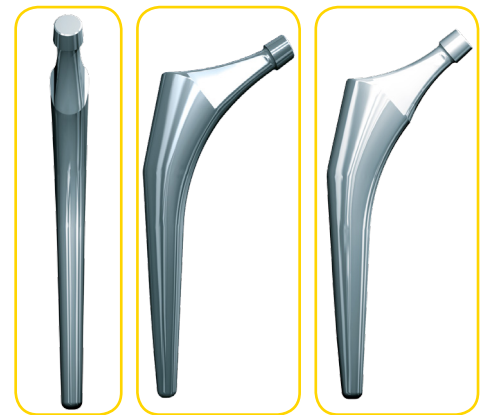

122° Cemented Stem 130° Cemented stem

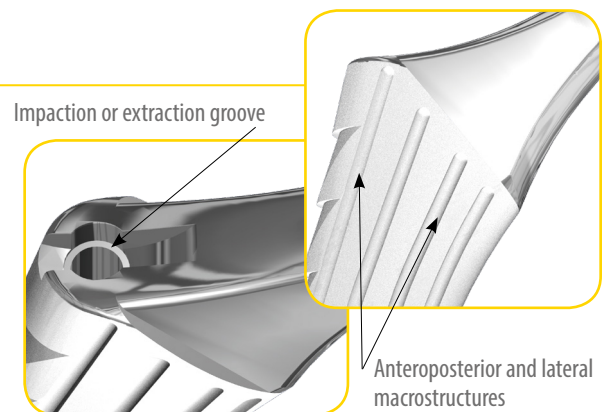
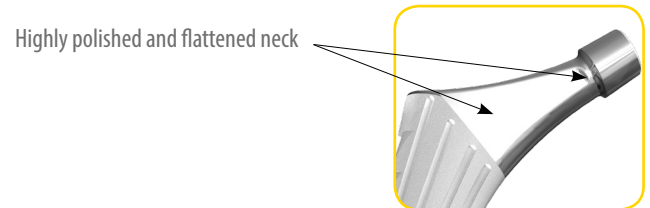

Coating

Cementless Hip'n go stems are coated with T40 titanium on the 2/3 proximal part and a total hydroxyapatite coating to enable secondary fixation.

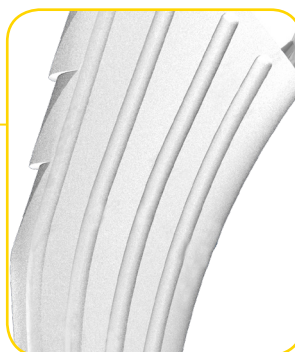

Instrumentation

The specific Hip'n go instrumentation set is a common instrumentation for all cemented and cementless stems available in this program.

This instrumentation allows all approaches to be used, including mini-invasive approaches.

Rasp handles are available for both posterior and anterior approaches.

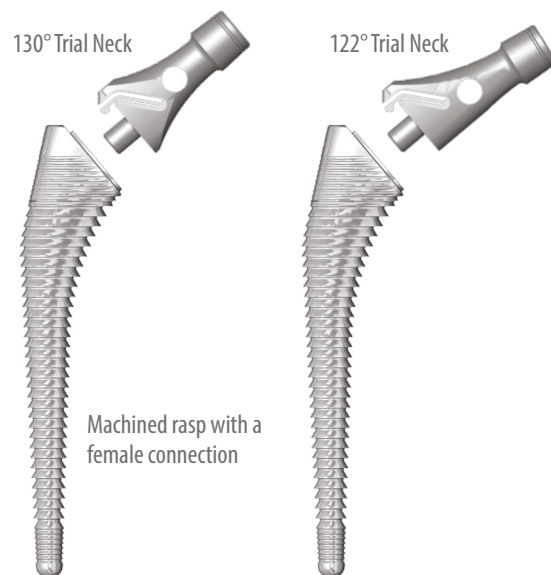
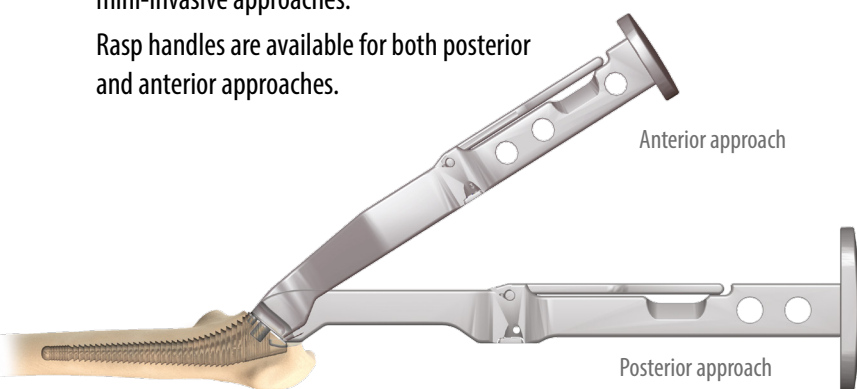

REFERENCES

[Cementless femoral stems]

STANDARD CEMENTLESS STEMS

256 597	Stem HNG 130° CL HAP S1
256 598	Stem HNG 130° CL HAP S2
256 599	Stem HNG 130° CL HAP S3
256 600	Stem HNG 130° CL HAP S4
256 601	Stem HNG 130° CL HAP S5
256 602	Stem HNG 130° CL HAP S6
256 603	Stem HNG 130° CL HAP S7
256 604	Stem HNG 130° CL HAP S8
256 605	Stem HNG 130° CL HAP S9
256 606	Stem HNG 130° CL HAP S10

CEMENTLESS VARIZED AND LATERALIZED STEMS

256 607	Stem HNG 122° CL HAP S1
256 608	Stem HNG 122° CL HAP S2
256 609	Stem HNG 122° CL HAP S3
256 610	Stem HNG 122° CL HAP S4
256 611	Stem HNG 122° CL HAP S5
256 612	Stem HNG 122° CL HAP S6
256 613	Stem HNG 122° CL HAP S7
256 614	Stem HNG 122° CL HAP S8
256 615	Stem HNG 122° CL HAP S9
256 616	Stem HNG 122° CL HAP S10

[Cemented femoral stem]

STANDARD CEMENTED STEMS

256 577	Stem HNG 130° C S1
256 578	Stem HNG 130° C S2
256 579	Stem HNG 130° C S3
256 580	Stem HNG 130° C S4
256 581	Stem HNG 130° C S5
256 582	Stem HNG 130° C S6
256 583	Stem HNG 130° C S7
256 584	Stem HNG 130° C S8
256 585	Stem HNG 130° C S9
256 586	Stem HNG 130° C S10

CEMENTED VARIZED AND LATERALIZED STEMS

256 587	Stem HNG 122° C S1
256 588	Stem HNG 122° C S2
256 589	Stem HNG 122° C S3
256 590	Stem HNG 122° C S4
256 591	Stem HNG 122° C S5
256 592	Stem HNG 122° C S6
256 593	Stem HNG 122° C S7
256 594	Stem HNG 122° C S8
256 595	Stem HNG 122° C S9
256 596	Stem HNG 122° C S10

REFERENCES

[Femoral heads]

BIOLOX FORTE CERAMIC HEADS

234 131	Taper 12/14 Ø28 (-3,5)
234 132	Taper 12/14 Ø28 (0)
234 133	Taper 12/14 Ø28 (+3,5)
250 729	Taper 12/14 Ø32 (-3,5)
250 730	Taper 12/14 Ø32 (0)
250 731	Taper 12/14 Ø32 (+3,5)
254 525	Taper 12/14 Ø36 (-3,5)
254 526	Taper 12/14 Ø36 (0)
254 527	Taper 12/14 Ø36 (+3,5)

STAINLESS STEEL HEADS

231 402	Taper 12/14 Ø22,2 (0)
231 403	Taper 12/14 Ø22,2 (+2)
231 391	Taper 12/14 Ø28 (-3,5)
231 392	Taper 12/14 Ø28 (0)
231 393	Taper 12/14 Ø28 (+3,5)
231 394	Taper 12/14 Ø28 (+7)

OTHER IMPLANTS OF THE RANGE

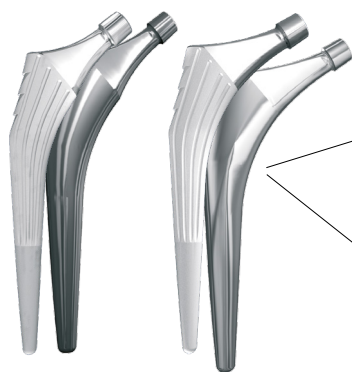

*Hip'n go
Straight stem cemented
or cementless 130° &
122° (122° cemented on
demand)*

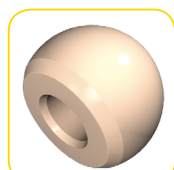

*Alumina
heads Ø32, 36mm*

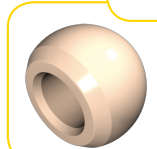

*Stainless steel,
CoCr, alumina
heads Ø28mm*



*Hip'n go
ceramic*



Hip'n go UHMWPE

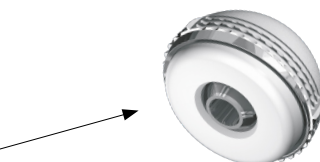

Hip'n go dual mobility press-fit



Hip'n go dual mobility Tripod



*Hip'n go cemented dual
mobility + Kerboul cross*

